



INSTALLATION INSTRUCTIONS

Accessory

ACCESSORY SOCKET
P/N 08U72-MKJ-D00

Application

CB1000RA

Publication No.

MII

Issue Date

January 2018

Honda Dealer: Please give a copy of these instructions to your customer.

PARTS LIST

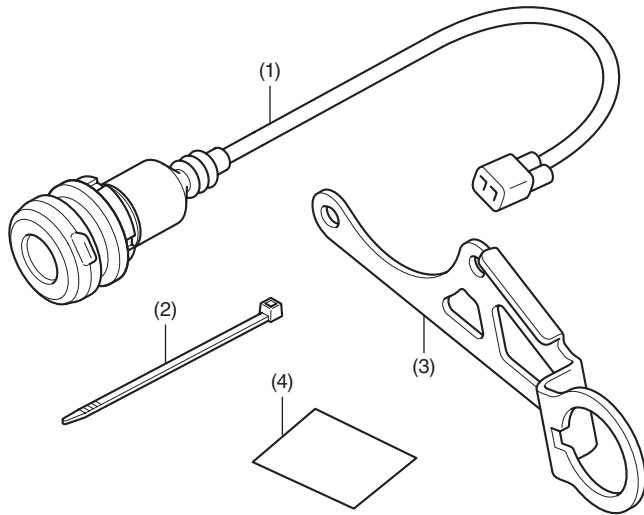

No.	Description	Qty
(1)	Accessory socket	1
(2)	Wire tie	1
(3)	Accessory socket stay	1
(4)	URL paper	1

TORQUE CHART

Refer to the Service Manual for the torque values of the removed parts.

INSTALLATION

NOTE:

- Refer to this manual and the Meter visor Installation Instructions when the motorcycle is equipped with the Meter visor.
- Disconnect the negative (-) cable from the battery before installing this accessory.
- The memories of the clock will be erased when you disconnect the battery. Reset the memories after reconnecting the battery.
- Reinstall the removed parts on the motorcycle and make sure that the wires and harnesses are not pinched.
- Cut the wire tie at 5 mm from the lock part after attaching them to the wire harnesses. Do not allow the cut part of the wire tie to interfere with another harness or brake hose.

1. Remove the pillion seat as shown.

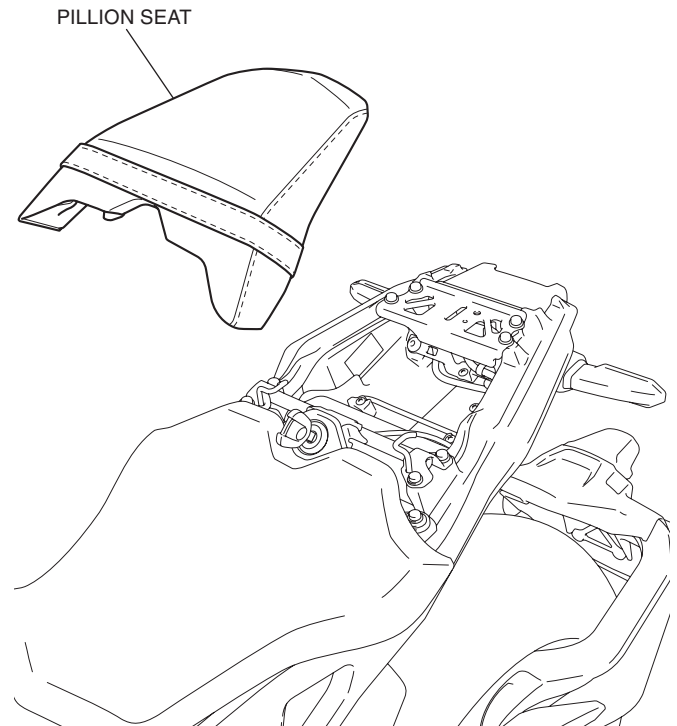

2. Remove the main seat and disconnect the negative (-) cable of the battery.

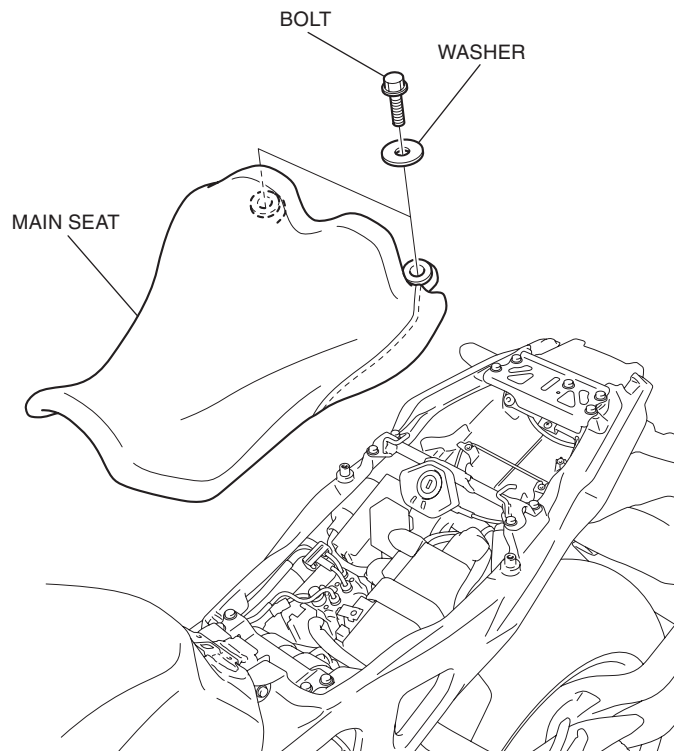

- Remove the meter visor as shown.
 - Perform this step for the motorcycle equipped with the meter visor.

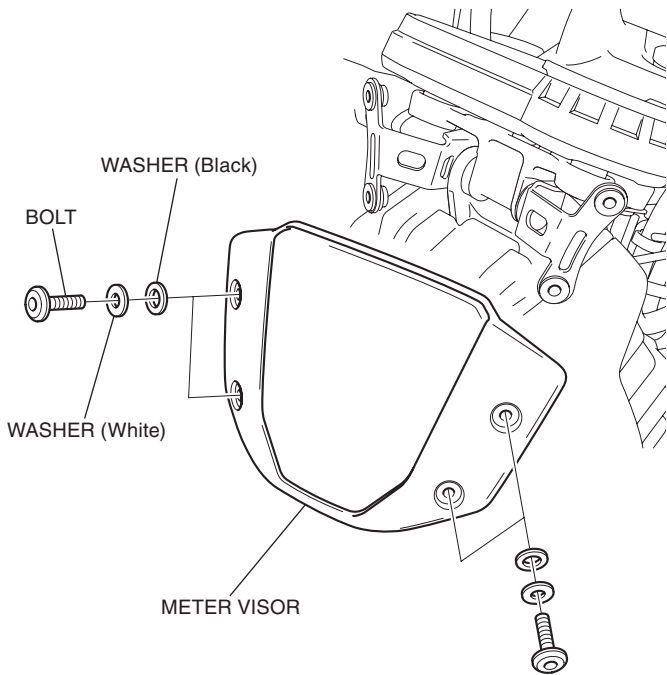

- Remove the bolt as shown.
 - Repeat on the right side.
- <Left side>

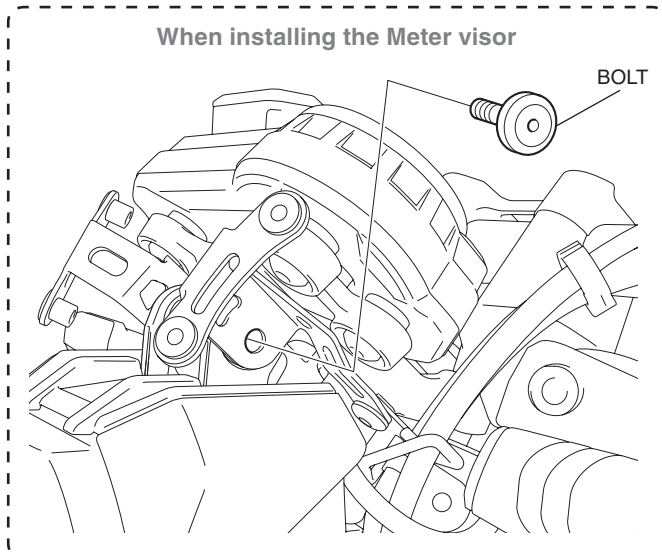
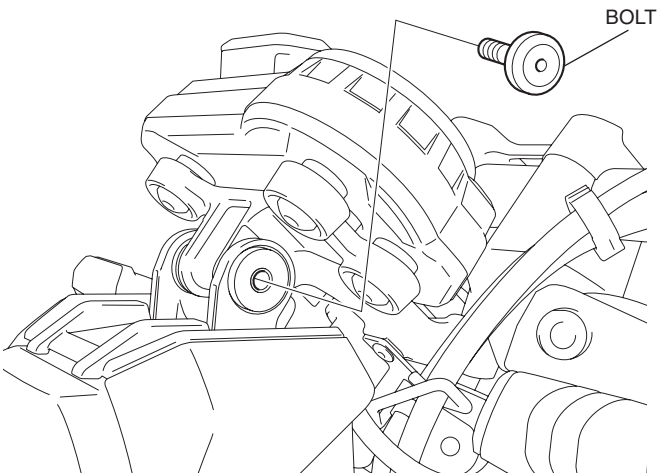

- Remove the headlight as shown.

HEADLIGHT
Disconnect the connector.

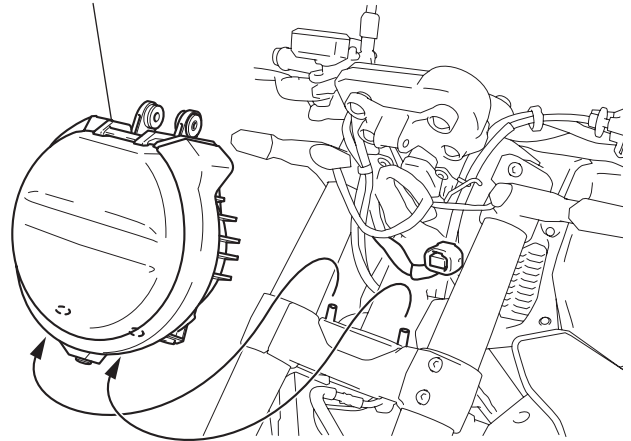

- Remove the collars as shown.
 - Perform this step for the motorcycle equipped with the meter visor.

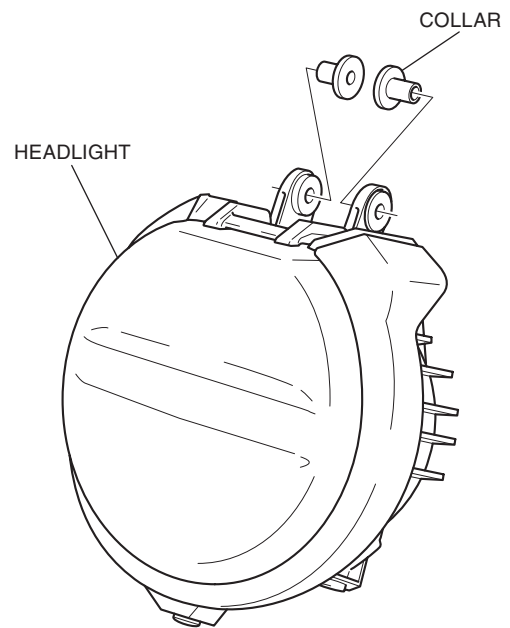

7. Loosely install the bolt and collar as shown.
- Perform this step for the motorcycle equipped with the meter visor.
 - Repeat on the right side.

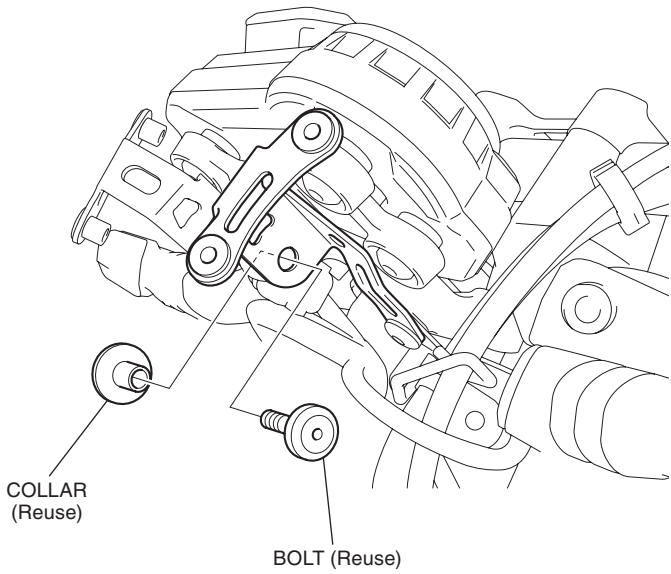

8. Move the cover as shown.

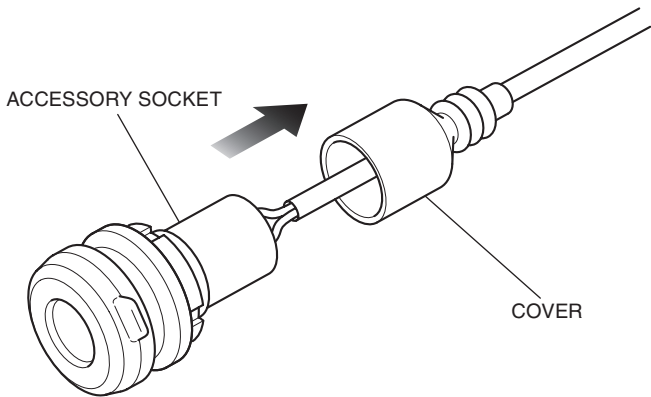

9. Remove the nut as shown.

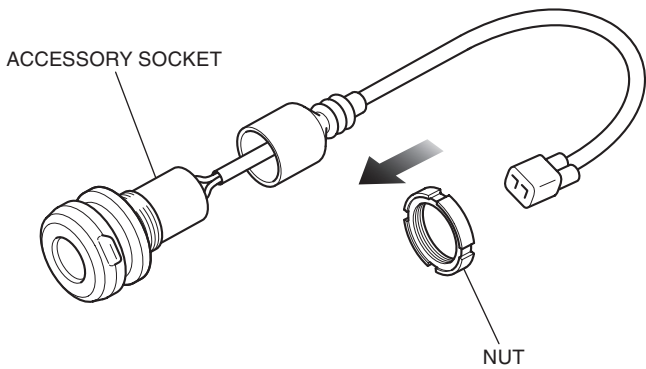

10. Assemble the accessory socket as shown.

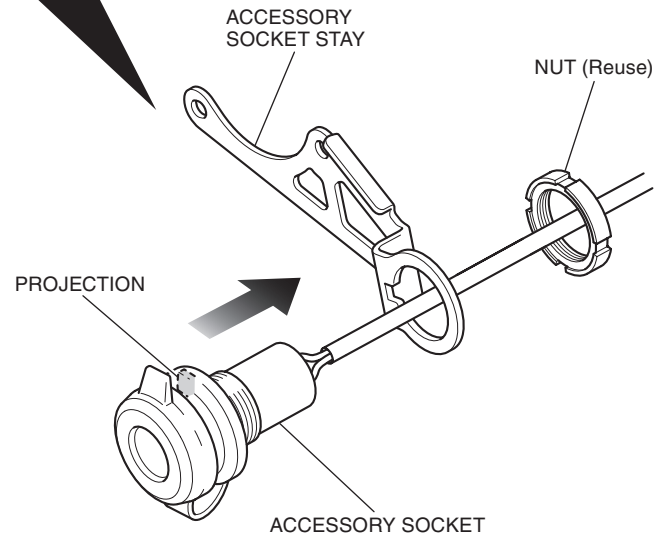
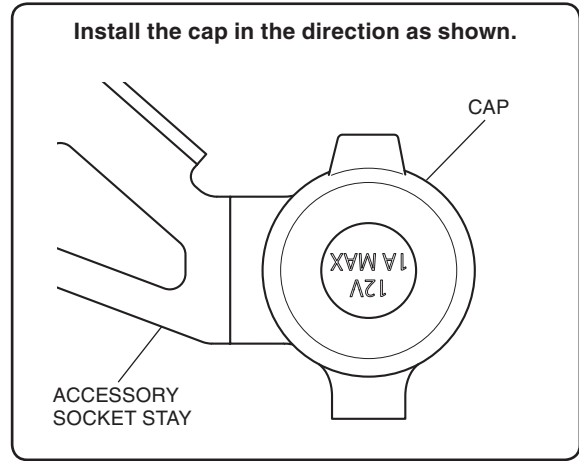

11. Install the cover as shown.

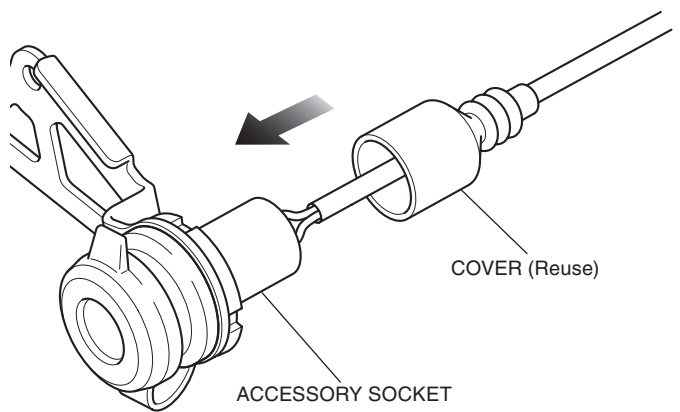

12. Remove the dummy connector as shown.

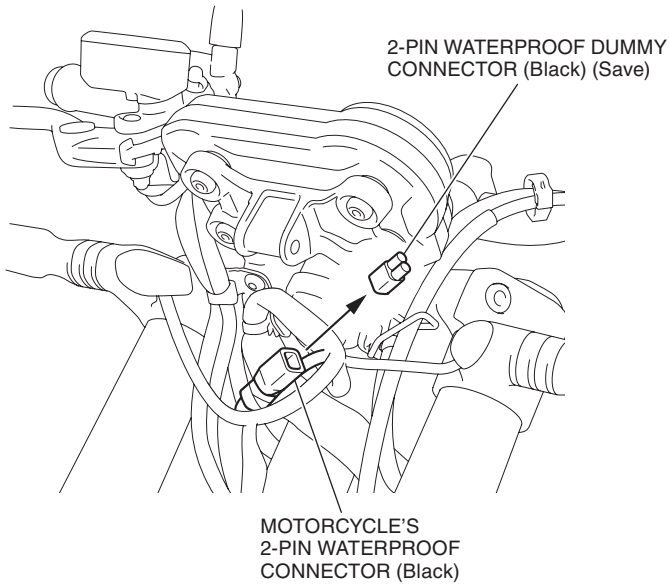

13. Remove the bolts as shown.

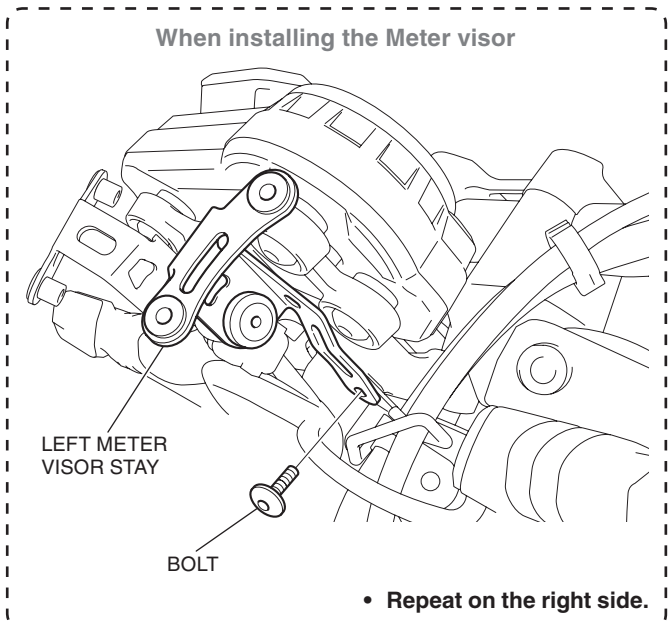
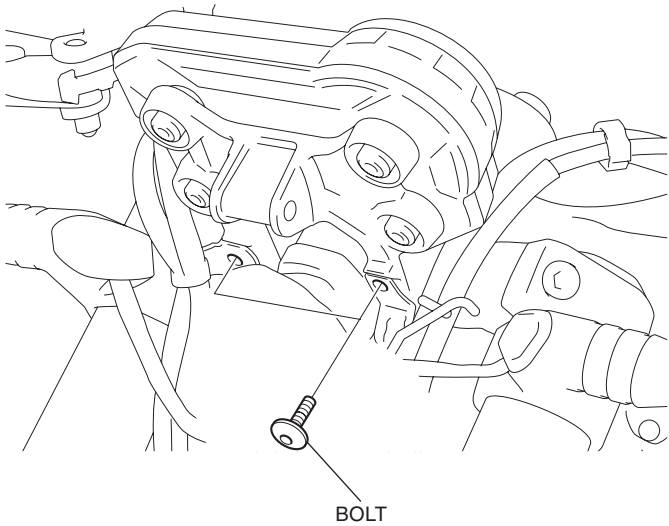

14. Install the assembled accessory socket as shown.

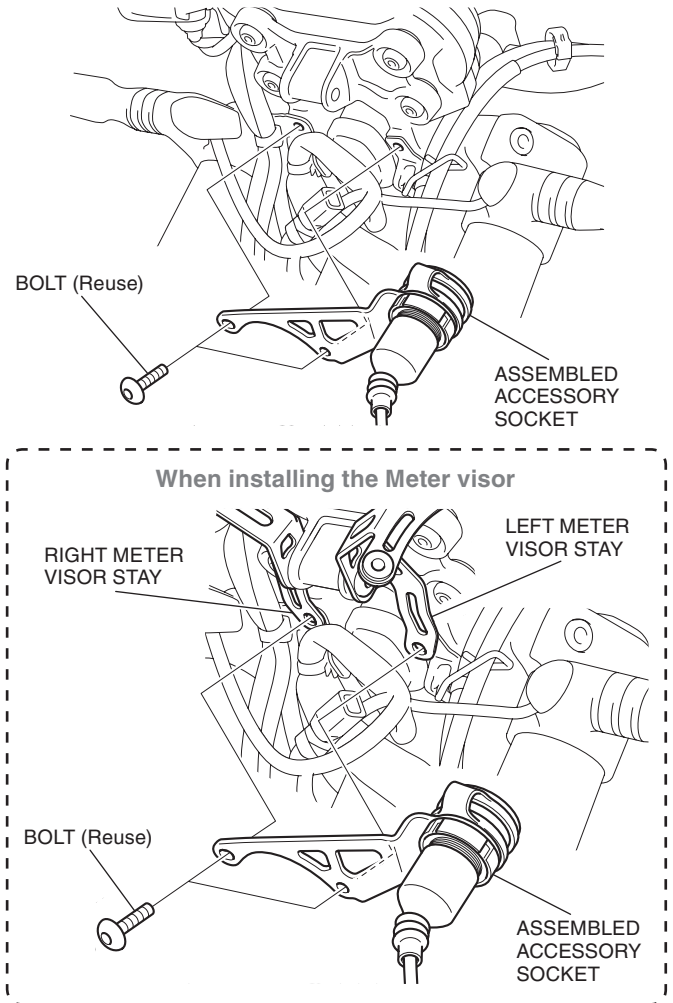

15. Remove the bolt and collar as shown.

- Perform this step for the motorcycle equipped with the meter visor.
- Repeat on the right side.

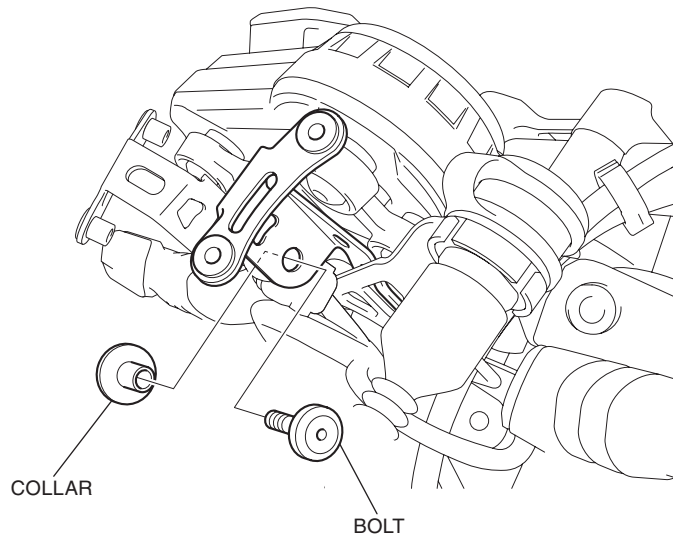

16. Install the collars to the headlight in the reverse order of removal.

- Perform this step for the motorcycle equipped with the meter visor.

17. Route and connect the accessory socket harness as shown.

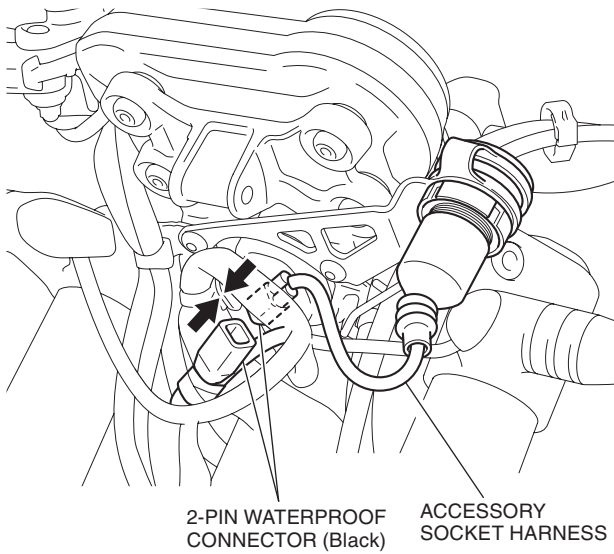

18. Secure the accessory socket harness with the wire tie as shown.

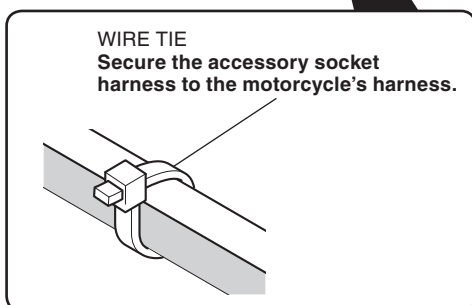
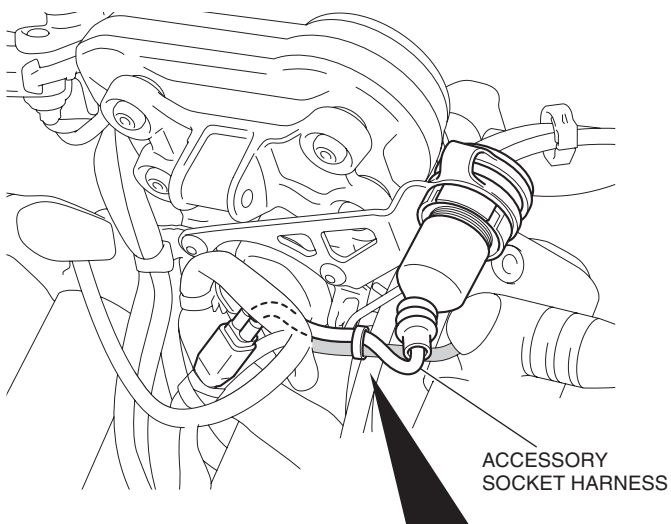

19. Install the motorcycle's parts in the reverse order of removal.
- **Confirm that any wire harness is not caught or too tight.**
20. Check the accessory socket, headlight and the other lights for proper operation.